

## What is Luma?

Luma is light. Luma means sunset, home and light - everything that has inspired this building to become a unique residential development for a community of successful, first-rate people like you.

## Why Luma Park Views?

**Unmatched luxuries:** Start a new fitness journey at your private gym, unwind by the sparkling pool, enjoy a meal at the cafe, and revel in the convenience of exclusive shopping experiences, **all in one building** - a vibrant community at your doorstep.

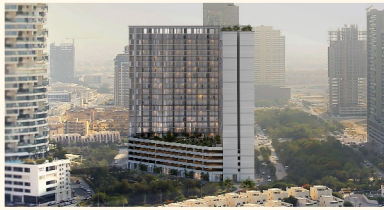

## Location

- Surrounded by numerous parks and kids' play areas
- In the heart of JVC on the bustling boulevard
- Adjacent to a 5-star hotel, the area's standout landmark
- Unobstructed views of parks and greenery in the surrounding area

Installment	Payment Percentage	Due date
Down Payment	20%	On booking
1st installment	5%	March 2024
2nd installment	5%	June 2024
3rd installment	5%	September 2024
4th installment	5%	December 2024
5th installment	5%	March 2025
6th installment	5%	June 2025
7th installment	5%	September 2025
8th installment	5%	December 2025
Completion	40%	June 2026

TownX has successfully delivered multiple residential projects across the city. The core value for every development is a focus on a user-centric experience where family comes first - linked with best-in-class specifications.

Apartment	Avg Size (sq ft.)	Starting Price (AED)
1-bedroom	838	1.05M
2-bedroom	1297	1.6M
3-bedroom	1505	1.66M



## Property Details

- Concierge service and organic coffee shop in the lobby
- High quality floor to ceiling double glazing window
- Retail outlets offering added convenience for residents
- Smart entry door locks
- Smart A/C thermostat system
- Double height grand lobby

## Amenities



- Art butterfly shaped garden
- Signature swimming pools (male/female)
- Signature gyms (male/female)
- Dedicated EV charges
- Jogging/walking track
- Kids play area